



Z-AXIS LIFTER

1. Overview

We designed Z-axis lifter to support our arc voltage torch height controllers to secure better control accuracy; even most OEM manufacturers make lifter on their own. HYD 's THC requests lifter motor Up/D own voltage below 2 V to secure high control accuracy of THC.

Specification,

Effective Stroke : 100mm

Maximum Speed : 1500mm /min

Motor: DC24V, 20W,

RPM : 3000 ,

Gear ratio: 6:1.

Lifter net weight: 2kg

Package in wooden : 2.5 kg

Picture of Lifter as follow, |





2. Wiring

TL100升降小车接线图 LIFTER WIRING INTRO

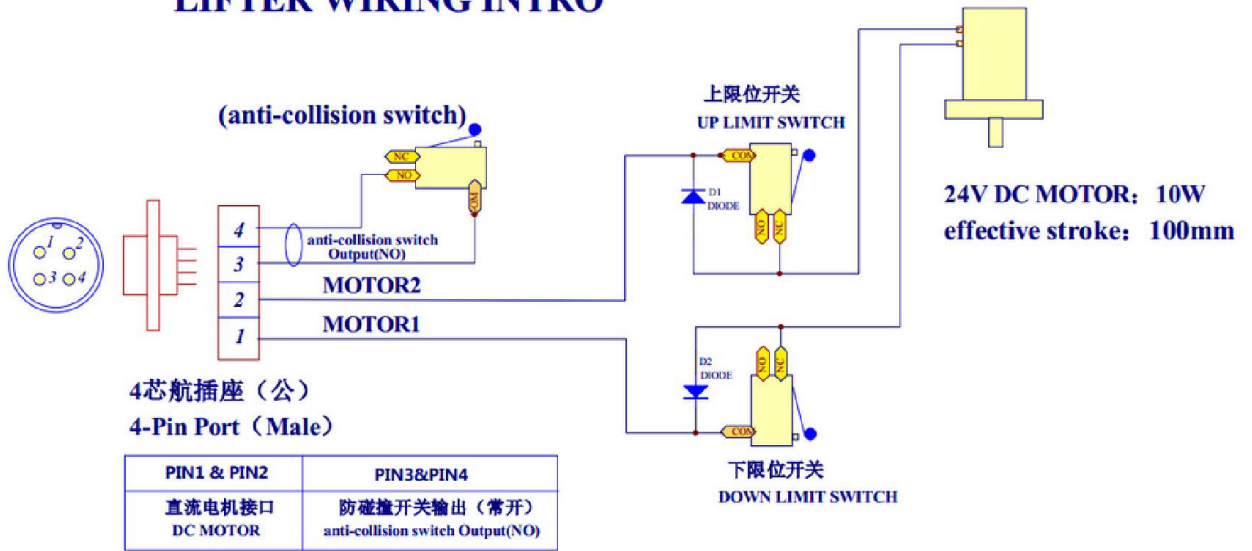

注意：1、升降小车位限位开关为常闭触点。

NOTE: 1.Limit switch is normally closed.

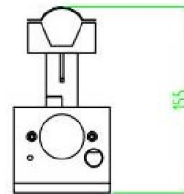
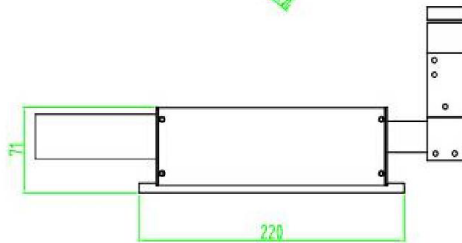
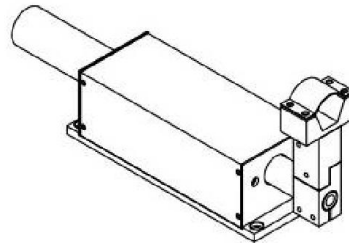
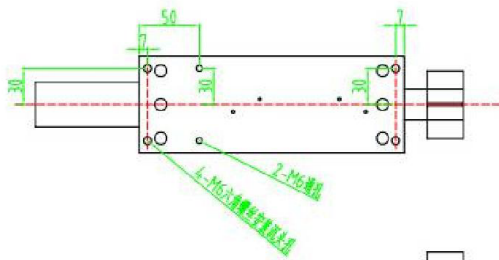

外形尺寸					
标号	规格	分区	更改文件号	签名	年、月、日
设计	(签名)	(年月日)	审核	(签名)	(年月日)
审核		数量	1		
工艺		数量			



We design the small lifter with Micro Switch inside.
Show the picture as below:

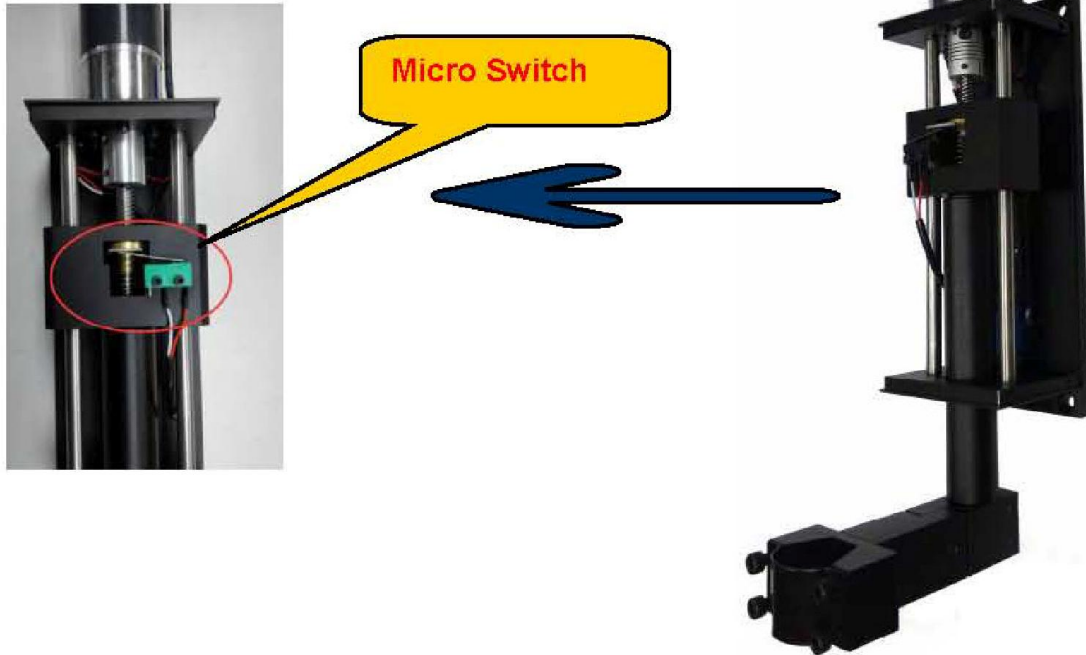

The Micro switch could be for the function of the IHS or Anti-collision signal, E-Stop etc.

For IHS function:

Connect it to the arc voltage XPTHC-4's IHS1 port as below. (Take the XPTHC-4 as a sample)



The micro switch in the small lifter works for HIS: When torch touches steel plate, activates this micro switch, sends out switch signal to THC to start IHS process.

If no THC, this signal can be sent to CNC for IHS function or anti-collision function too.